

0040 GUIA ALA LATERAL 120 MM

0041 GUIA ALA CENTRAL 120 MM

0081 GUIA ABIERTA 120 MM

* BAJO PEDIDO

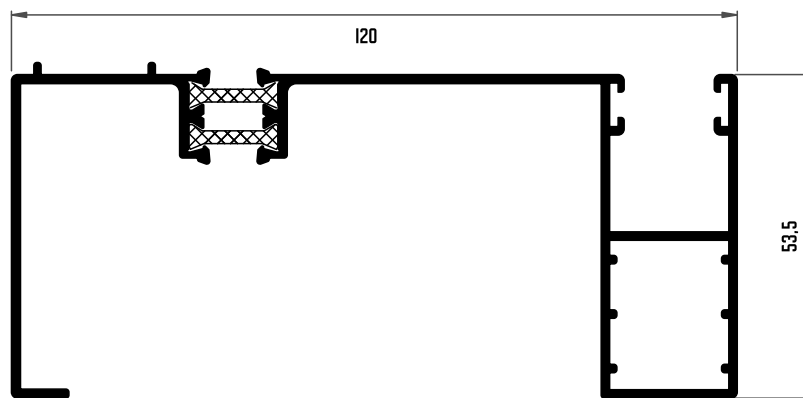

R-38 GUIA

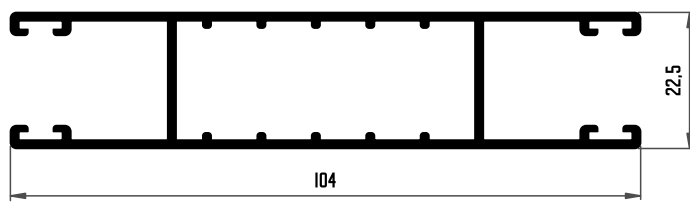

0072 GUIA DOBLE 104 MM

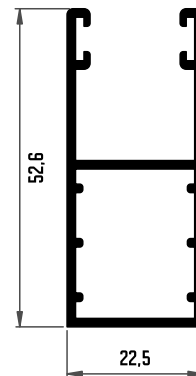

0042 GUIA SIN ALETA

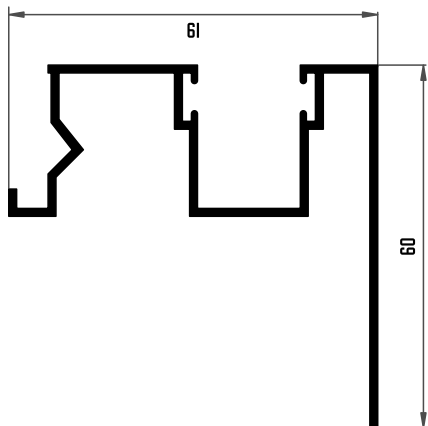

0047 GUIA POLIPEL CON ALA

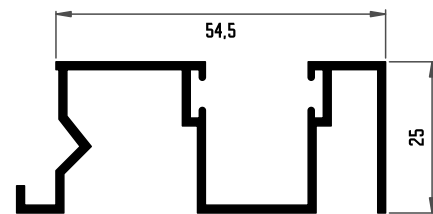

0046 GUIA POLIPEL

* BAJO PEDIDO

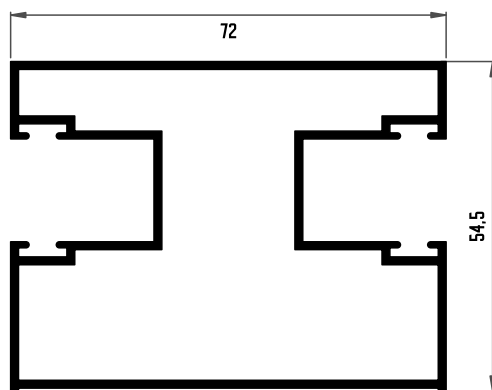

0048 GUIA DOBLE POLIPEL

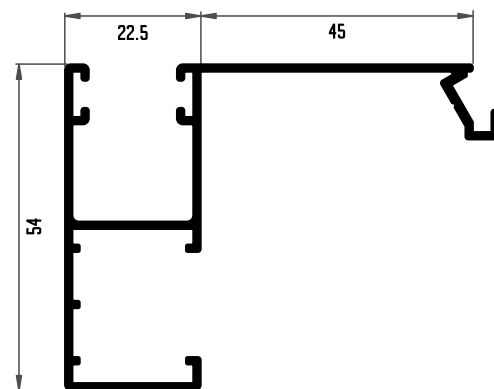

III35 GUIA

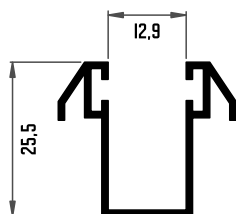

0043 GUIA 25.5 MM

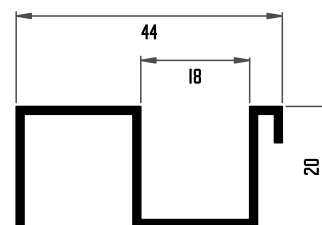

0045 GUIA 44X22 MM

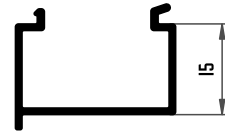

0067 ACOPLA 15 MM

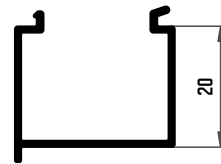

0068 ACOPLA 20 MM

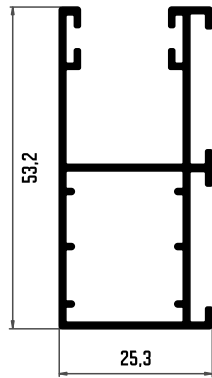

0066 GUIA DE ACOPLA

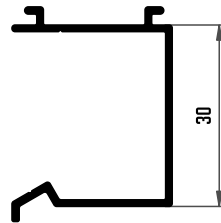

0069 ACOPLA DE 30 MM

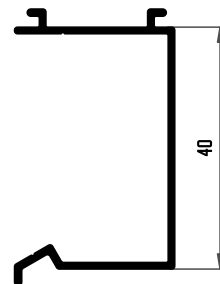

0070 ACOPLA DE 40 MM

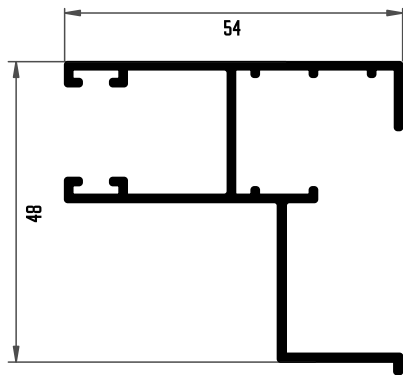

0065 GUÍA 48 mm

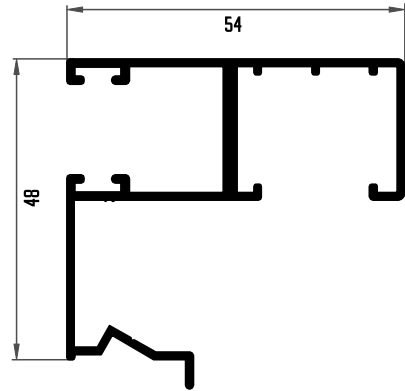

0087 GUÍA 48 mm LATERAL

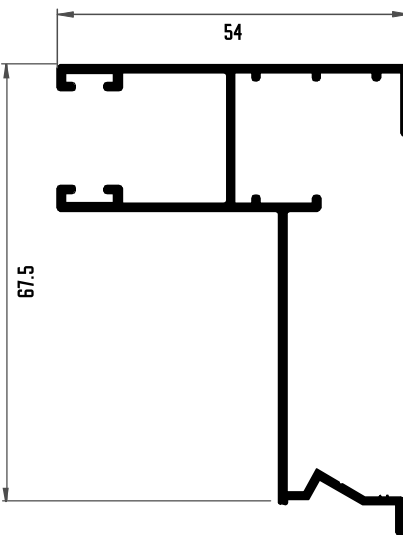

0088 GUÍA 67.5 mm

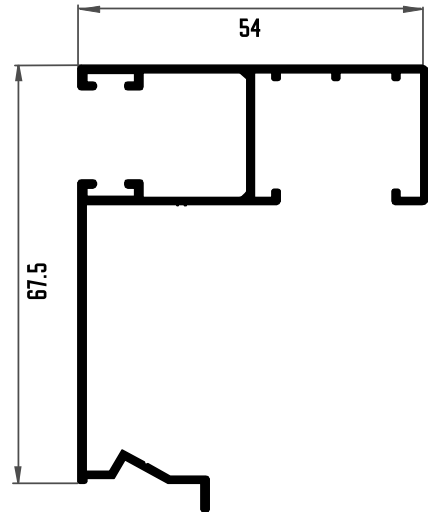

0089 GUÍA 67.5 mm

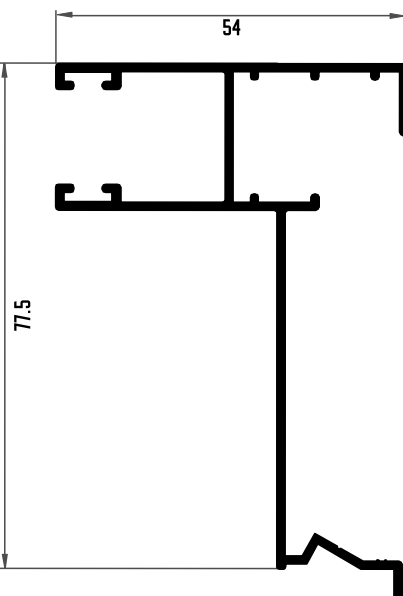

0090 GUÍA 77.5 mm DESPLAZADA

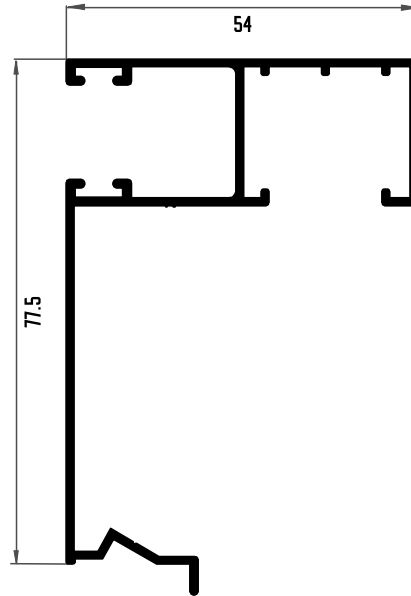

0091 GUÍA 77.5 mm

MONTAJE DE GUÍAS

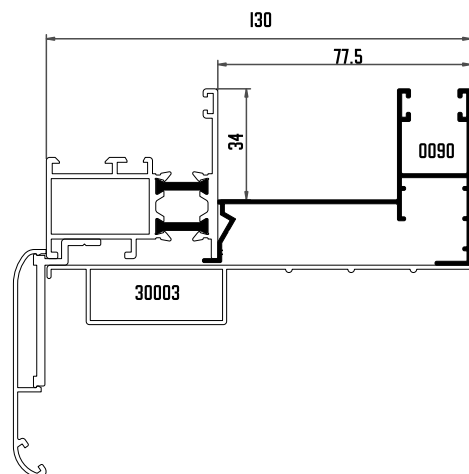
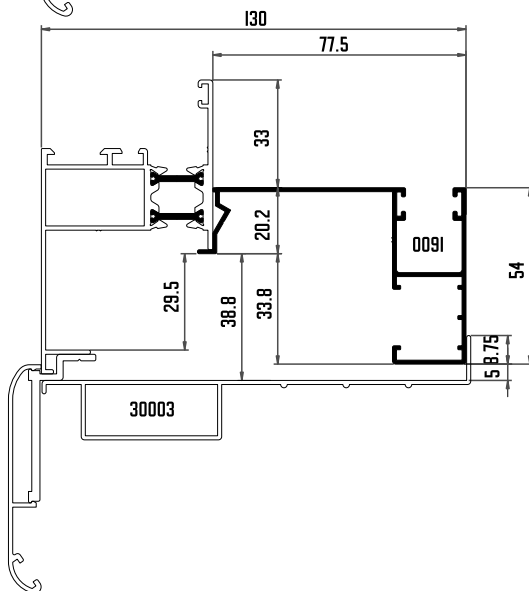
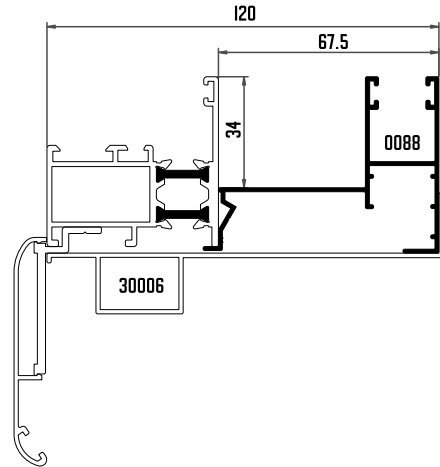
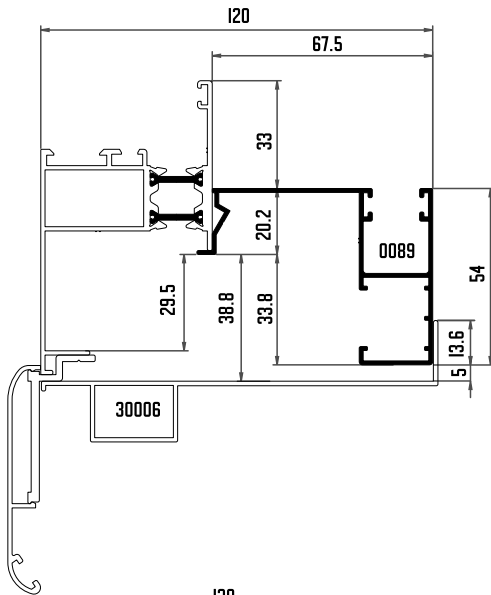
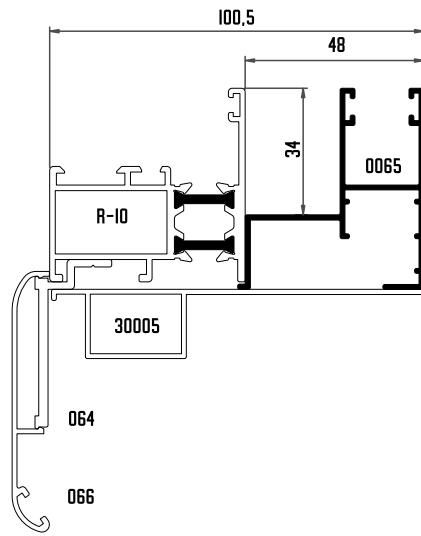
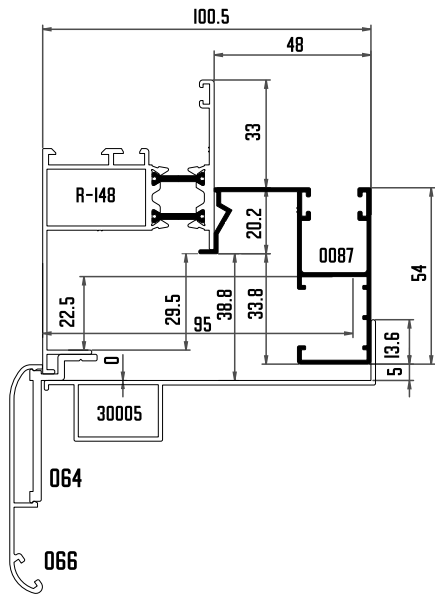

TROQUEL PARA R-156 MARCO SOLAPE GUÍA

SERIE 10

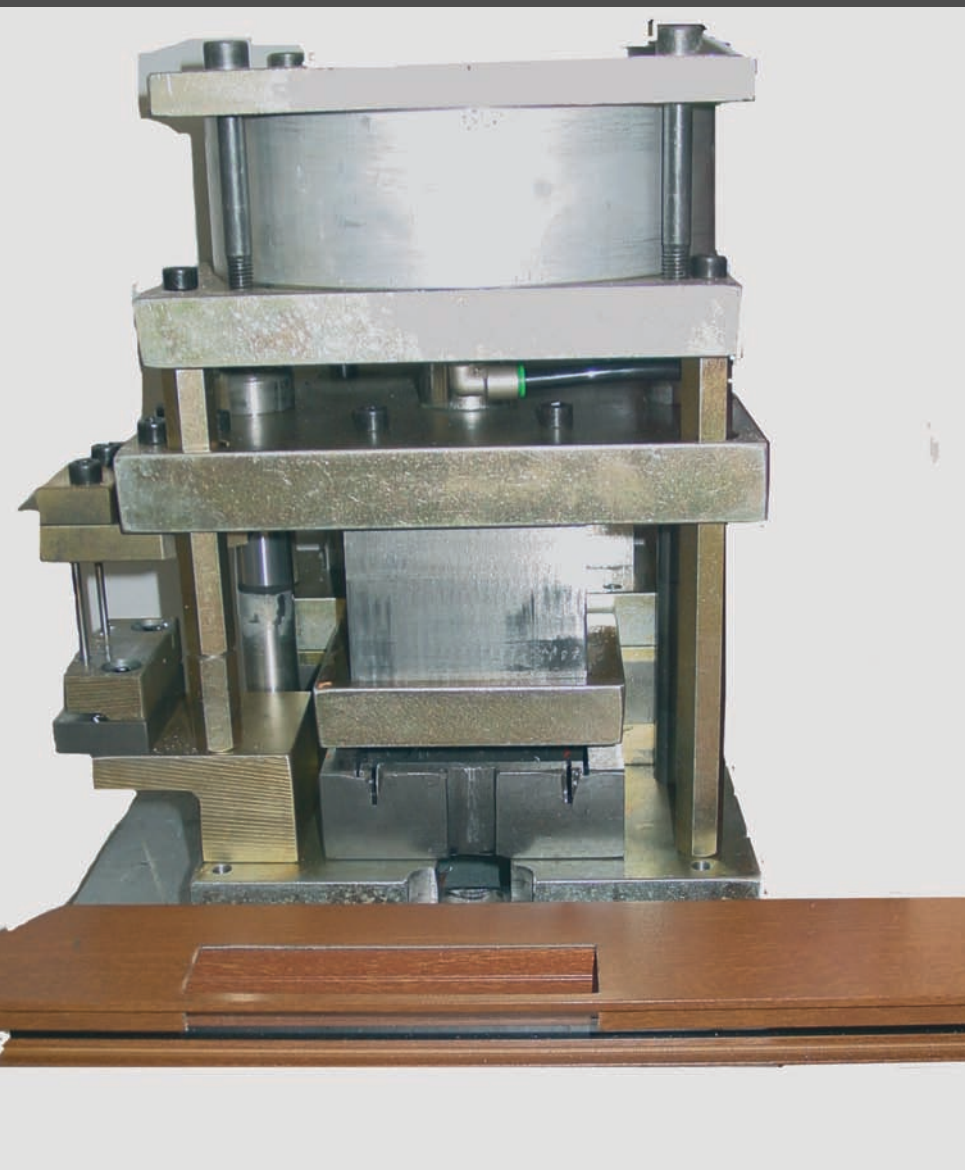

MECANIZADO DE:

- CAJETÍN MONOBLOCK.
- AGUJEROS ACOPLA JAMBA REFERENCIA 064.
- SOBRA SOLAPE PARA INGLETE CON MARCO REFERENCIA R-10.